









## DOMAINE DE PRIMARD

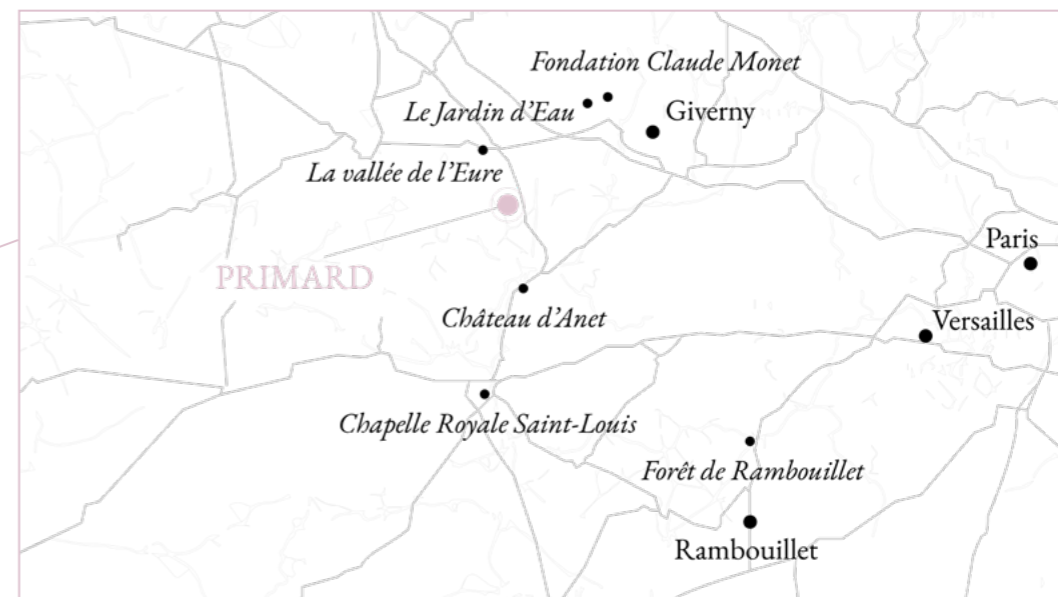



## AN ESCAPE LESS THAN ONE HOUR FROM PARIS



-  1h by car from Orly, Charles de Gaulle and Le Bourget airports
-  50min by car from London heliport
-  50min by car from Paris train stations
-  55min from Paris
-  25min from Giverny
-  20min from Dreux



## ALONGSIDE THE EURE

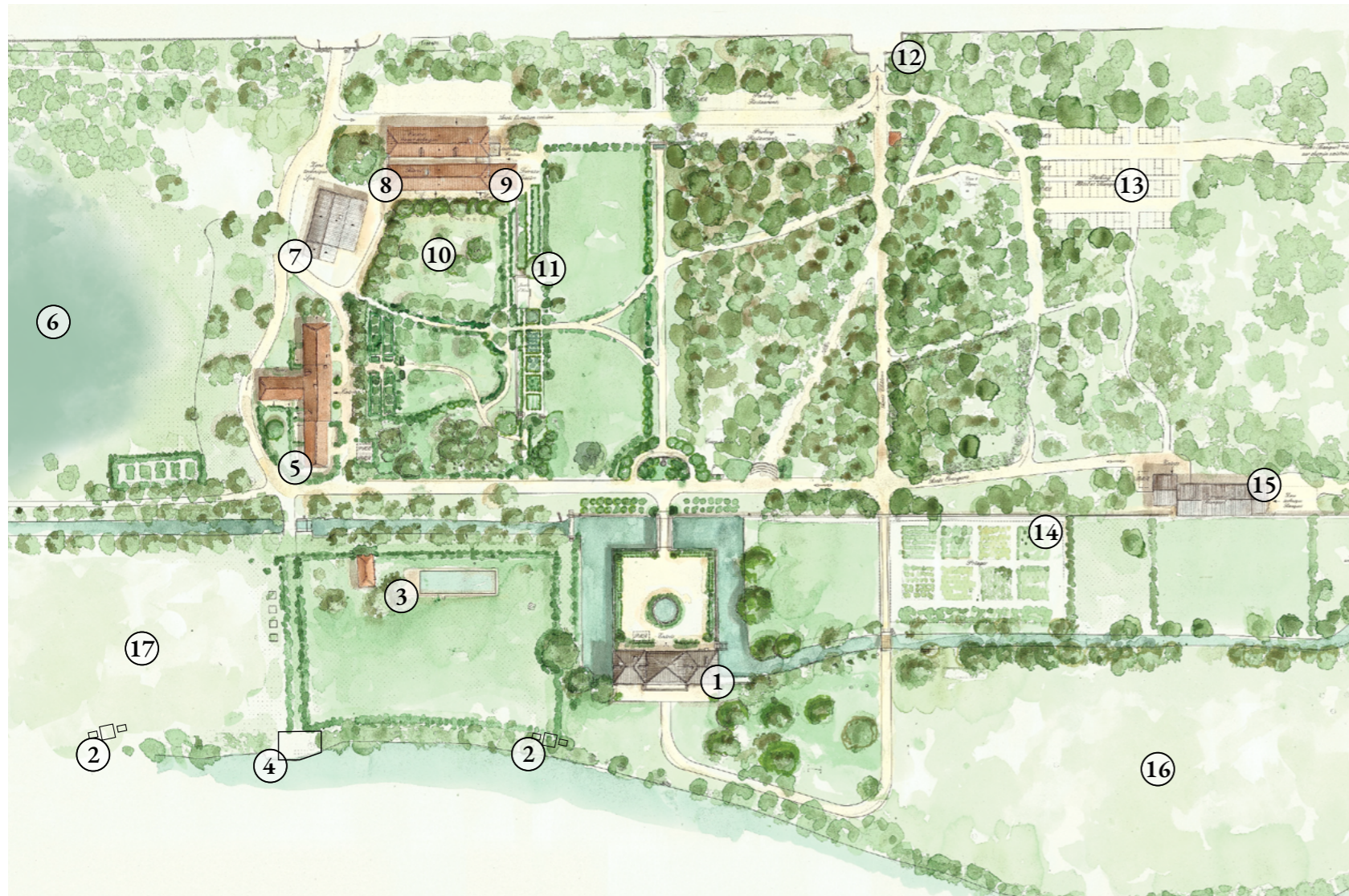

- ① Maison sur l'Eure
- ② Reading deck
- ③ Swimming pool
- ④ Bar on the Eure

- ⑤ Maison du Lac
- ⑥ Lake
- ⑦ Barn
- ⑧ Susanne Kaufmann spa

- ⑧ Maison du Verger  
Bistrot Octave
- ⑨ Maison du Verger  
Églantine restaurant

- ⑩ Orchard
- ⑪ Rose Garden & greenhouse
- ⑫ Main entrance
- ⑬ Car park

- ⑭ Vegetable garden
- ⑮ Reception room
- ⑯ Animal park
- ⑰ Horses



- 39 KEYS**
- 30 rooms
  - 9 suites



- 3 RESTAURANTS**
- Églantine, gastronomic restaurant - 30 seatings
  - Octave, gourmet bistro - 80 seatings
  - La Table d'Hôte - 12 seatings



- 2 BARS**
- 1 bar in the Maison sur l'Eure
  - Des Ronds dans l'Eau, outdoor bar floating on the Eure



- 1 PARK OF 40HA**
- 1 rose garden
  - 1 vegetable garden of 1ha
  - 1 pond
  - Animals



- 1 RECEPTION ROOM**
- Capacity of 200 people
  - Seminars & weddings

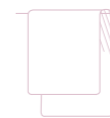

- 1 SUSANNE KAUFMANN SPA**
- 4 treatment rooms
  - 1 sauna / 1 hammam
  - 2 Japanese baths





## KEY POINTS



### DOMAINE DE PRIMARD

*The elegance of an 18th century residence.*

*The possibility of an island 1 hour away from Paris.*

*A Domaine that offers more than 40 hectares on the banks of the Eure.*

*A remarkable garden created by Jacques Wirtz 35 years ago.*

*A representative plan of the Ancien Régime properties including a noble house, old agricultural buildings around an orchard, a farm, a longère, a stake and a vegetable garden.*



### GEOGRAPHIC LOCATION

*1 hour away from Orly, Charles de Gaulle and Le Bourget airports.*

*50min away by car from London heliport.*

*50min away by car from all Parisian train stations.*

*55min away from Paris.*

*25min away from Giverny.*

*20min away from Dreux.*



### A NATURAL PRESERVED ENVIRONMENT

*A garden created by the Belgian landscape designer Jacques Wirtz.*

*A collection of rare trees and over 250 varieties of roses.*

*Animals which maintain the meadows and animate the landscapes.*

*A permaculture vegetable garden that supplies the 3 restaurants of the Domaine.*



### A WINDOW ON NATURE

*39 rooms and suites located in 4 different buildings.*

*Price range from 500€ to 800€ in high season for a surface area from 22 to 60 sq m.*



## KEY POINTS



### WELLNESS AND RELAXATION

*A 450m<sup>2</sup> spa developed on two levels.*

*On the ground floor: sauna, hammam, hot and Japanese baths.*

*Upstairs: 4 treatments rooms and fitness room equipped with WaterRower equipments.*

*Susanne Kaufmann natural protocols created from precious natural oils and pure unprocessed products.*

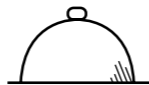

### GASTRONOMY

*A seasonal cuisine using the best local products in an eco-responsible approach.*

*Fruits and vegetables that come from the Domaine's organic vegetable garden.*

*A gastronomic restaurant, Églantine, which highlights the excellence of the best local products.*

*A bistro, Octave, which pays tribute to a traditional French cuisine.*

*La Table d'Hôtes which invites you to an exclusive experience with an intimate atmosphere.*



### EXPERIENCES

*A multitude of opportunities to live a unique experience close to nature.*

*Gastronomic experiences: dinner in the rose garden, wine tasting in the cellar...*

*Sports experiences: bike ride, canoe, fishing...*

*Visit of the surroundings: discovery of Anet, the Eure Valley, Giverny and Claude Monet's gardens...*



### AFFILIATIONS / GDS

*Relais & Châteaux  
Virtuoso  
Internova / Select  
Mr & Mrs Smith  
Tablet Plus*

*Amadeus (1A) - WBLBGDDP  
Sabre (WB) - 392657  
Galileo / Apollo (WB) - 84512  
Worldspan (1P) - WBCDGDGP*